

Submersible pump

GA 200 50 Hz

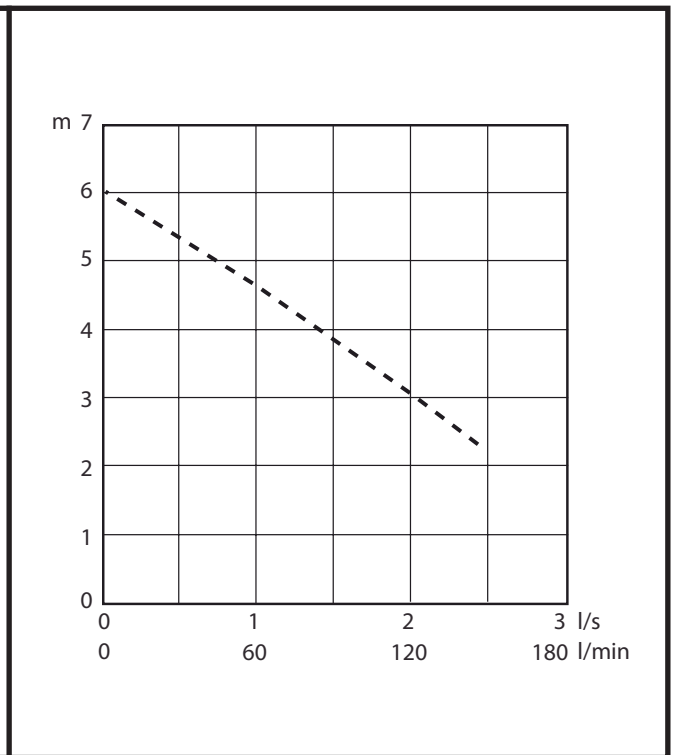
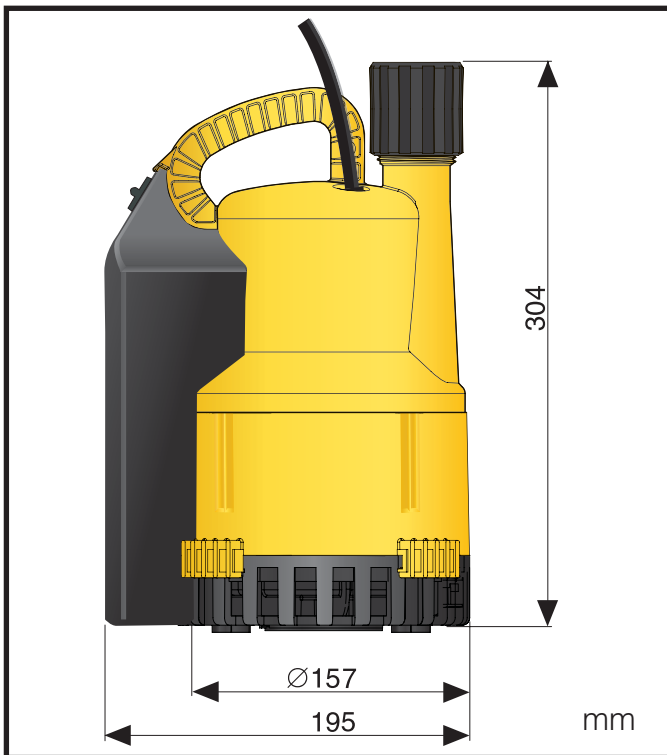

GA 200.02.1011.Eng/Digital
The manufacturer reserves the right to alter performance, specifications or design without notice.

Specification

Electric submersible pump for clear and contaminated water with a wide range of applications wherever water has to be moved.

It is ideally suitable for many operations at farms, homes and gardens. Filling and emptying of pools and tanks, pumping out flooded basements and boats, irrigation and flushing or in permanent installations as a sump pump.

Pump Types

GA 200 medium head, single-phase.

Electric Motor

Single-phase motor with built-in capacitor.

Motor rating P_1 : 0,36 kW

Speed: 2900 rpm

Voltage, V	230
Nominal current, A	1,6

Power Cable

10 m type HO7RN-F 3 x 1,0 mm² with plug and strain relief.

Motor Protection

Built-in with automatic cut-off in case of overloading.

Shaft Seal

Special lip seals.

Materials

Motor housing and shaft: Stainless steel
Outer casing and strainer: Corrosion-resistant synthetic material

Discharge Spigots

G 1 1/4" BSP-thread (G) internal with built-in checkvalve.
Hose adapter included as standard.

Weight (without cable)

3,8 kg

Permanent installation sump pump

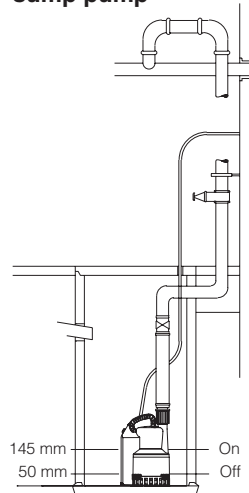

Combination spigot with possibility for connecting hose or pipe of different dimensions.

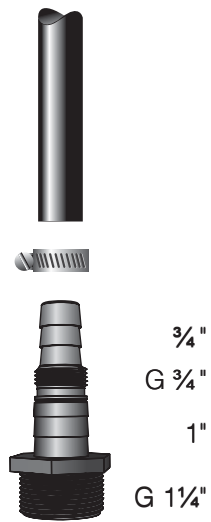

The pump has a built-in automatic level control device. Change-over to continuous operation is easily done with a switch on the side of the pump.

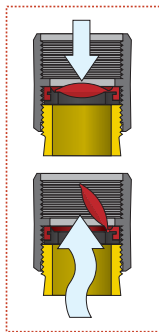
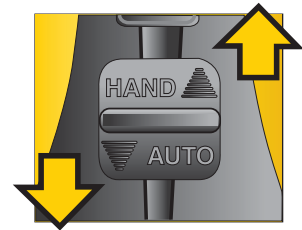

Built-in check valve in the discharge connection blocks return flow when the pump is switched off.

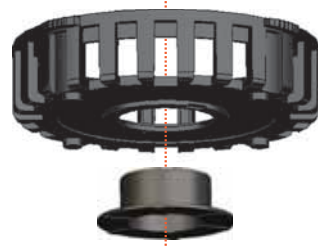
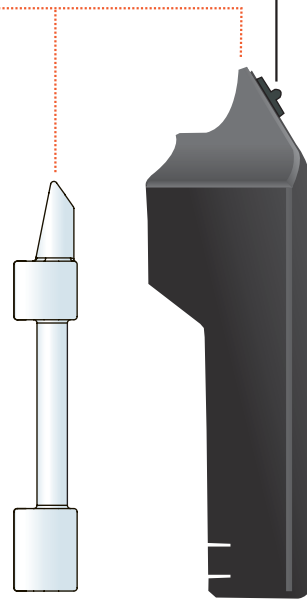
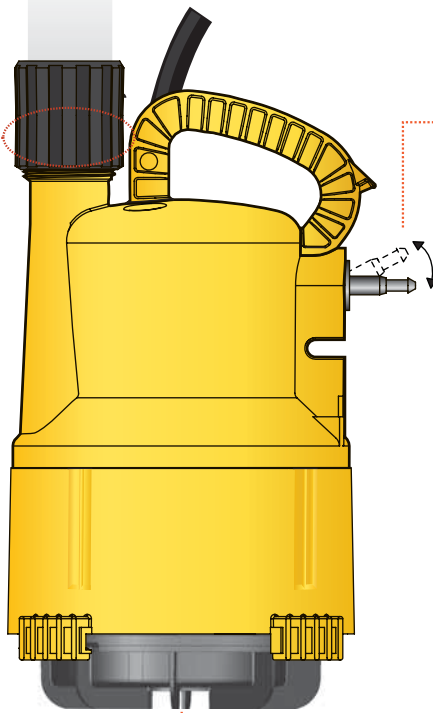

Detachable suction ring. When fitted into the impeller screen allows pumping down to 3 mm (manual operation only).